

Courses & Distances  
up the River.

1 S.	22	E. 20
2 S.	62	W. 49
3 S.	40	E. 21
4 S.	34	W. 68
5 S.	12	W. 18
6 S.	13	E. 20
7 S.	39	E. 20
8 S.	24	W. 35
		251

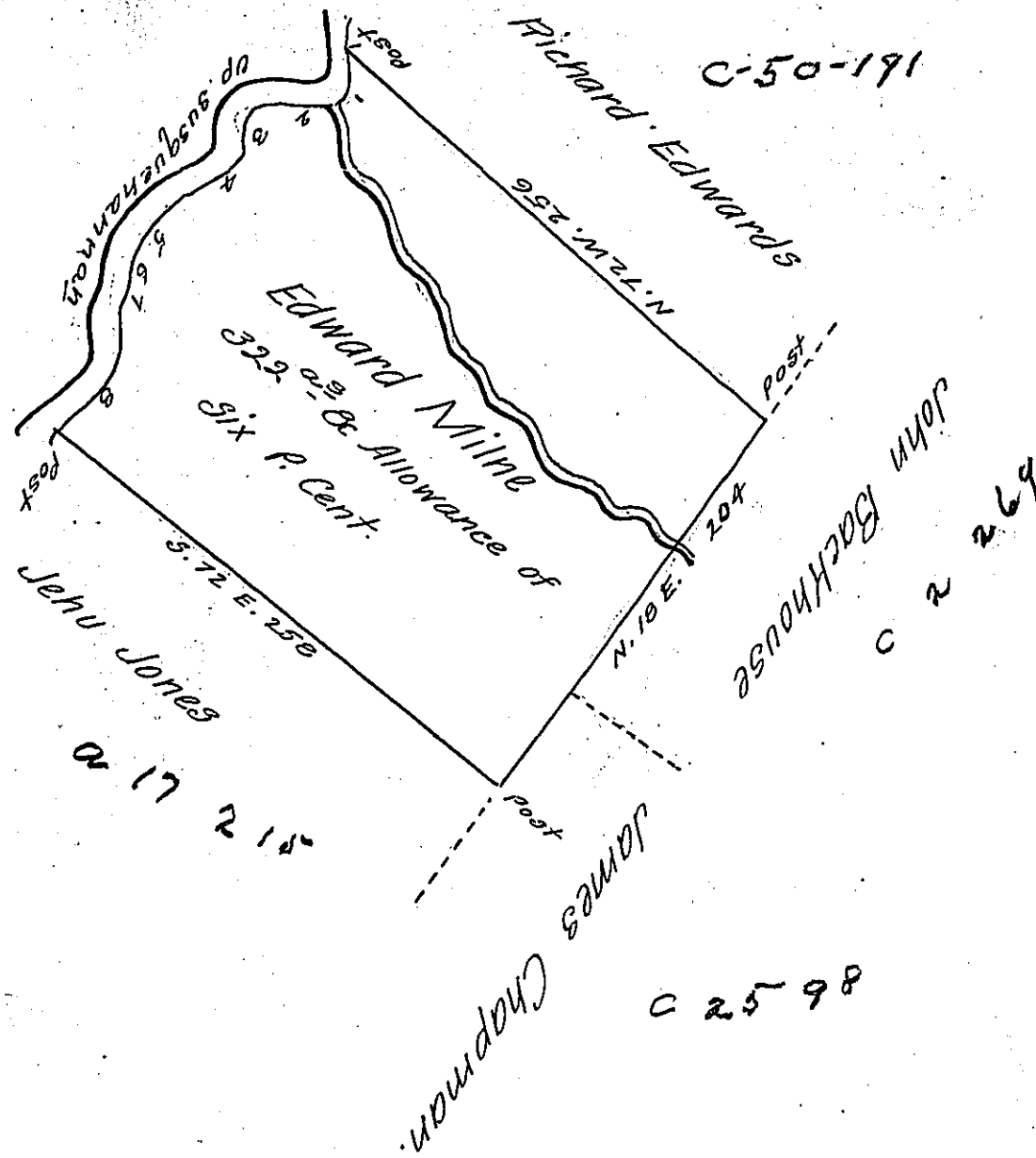

A Draught of a Tract of Land called the Landing Place,  
 Situate on the Southerly side of the West Branch of Susquehanna adjo-  
 -ining & below Land of James Chapman - others between four & five Miles  
 below the Canoe Place in County of Bedford containing three hundred  
 & twenty two Acres &c. Surveyed the 2<sup>d</sup> Day of November 1775 for Edw-  
 -ard Milne in Pursuance of a Warrant Dated the Thir- Day of August  
 1773 by

Thomas Smith D.S.

To John Lukens Esq<sup>r</sup>  
 Surveyor General.

IN TESTIMONY that the above is a copy of the original remaining on file in  
 the Department of Internal Affairs of Pennsylvania, made  
 conformably to an Act of Assembly approved the 16th day of  
 February, 1833, I have hereunto set my Hand and caused  
 the Seal of said Department to be affixed at Harrisburg,  
 this twenty-eighth day of November 1905

*Grace D. Brown*  
 Secretary of Internal Affairs.